

Plat of Survey

of

Lot 1 of Certified Survey Map No. 4280,

recorded in Vol. 27 of Certified Survey Maps of Walworth County on Page 226 and located in the Northwest 1/4 of Section 15 and the Northeast 1/4 of Section 16, Town 3 North, Range 15 East, Town of Richmond, Walworth County, Wisconsin.

Surveyed for: **Neal Brewer**
222 Elm Street
Delavan, Wisconsin. 53115

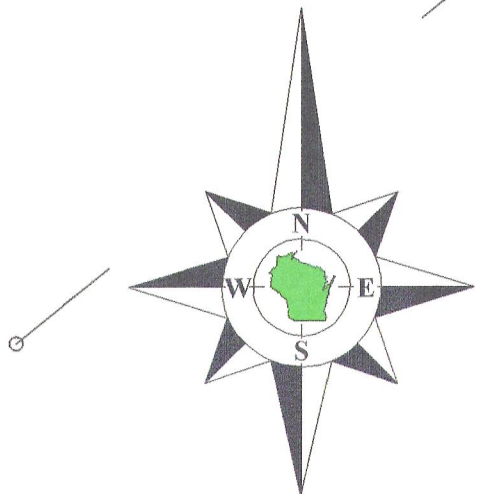

Bearings reference to Certified Survey Map No. 4280.

County Trunk Highway A
(Width Varies)

Lot 1

Tax Parcel
CA428000001

0.567 Acre
24,719 Sq.Ft.

Tubby's Too
W8497

Open Sided Pavilion

House

Garage

Johnson Road
(Width Varies)

Lot 6
Pine Edge
Subdivision

Tax Parcel
CR 1500006

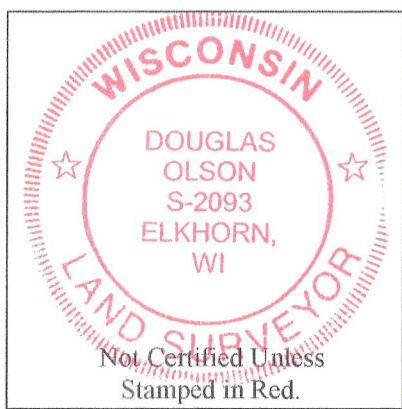

Notes:

- 1) This survey plat is not certified unless signed and sealed in red ink.
- 2) This survey is subject to Wisconsin lien laws. This Plat of Survey is the notice of intent to file lien. Lien waiver required.

Copyright 2002 by Jensen & Olson Land Surveying, LLC.

All rights reserved. No part of this survey plat may be reproduced or transmitted in any form by any means - graphic, electronic, or mechanical, including photocopying, tracing, or information storage and retrieval systems - without permission in writing from Douglas G. Olson, Jensen & Olson Land Surveying, LLC.

I, Douglas G. Olson, Wisconsin Registered Land Surveyor, do hereby certify that this survey was performed by me, or under my direction in full compliance with the owner's/agent's instructions and Chapter A-E 7 of the Wisconsin Administrative Code "Minimum Standards for Property Surveys"; and that this map is an accurate representation thereof to the best of my knowledge and belief.

Douglas G. Olson
Wisconsin Registered Land Surveyor - 2093

2011.045

Sheet 1 of 1 Sheets

Drawing Name: Gnr15e-2011045-2011045Plat.sj

Job Reference Number

2011.045

Legend

- Found County Section Corner
- Found Highway Monument
- Found Iron Pipe
- Found Conc. Cover
- Metal R.O.W. Post
- Utility Pole
- Found Iron Rod, 3/4" dia.
- Recorded Information
- Concrete
- Asphalt
- Gravel



Jensen & Olson Land Surveying, LLC

45 South Wisconsin Street * P.O. Box 322 * Elkhorn, Wisconsin. 53121

Telephone: (262) 723-3434 * Facsimile: (262) 723-8044

Email: jensen.olson@elknet.net

Scale in Feet
1" = 20'

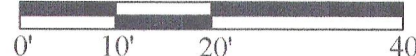

Survey Date: November 27, 2001.

Revisions: No. 1 - Proposed Shed
No. 2 - Johnson Road
No. 3 - New ROW line
No. 4 - Proposed "Pavilion"
No. 5 - As-built "Pavilion" & CSM recording information.

CA4280-1

315-1103